

- **IMPORTANT:** The tank must be surrounded in concrete as per installation procedures. Refer to installation manual available from Dutypoint Ltd.
- Inlets and cable entry points to be formed in the correct positions to suit site requirements. Further detail is available in the installation manual
- Dimensions are approximate due to manufacturing tolerances. If critical, check physically prior to installation.

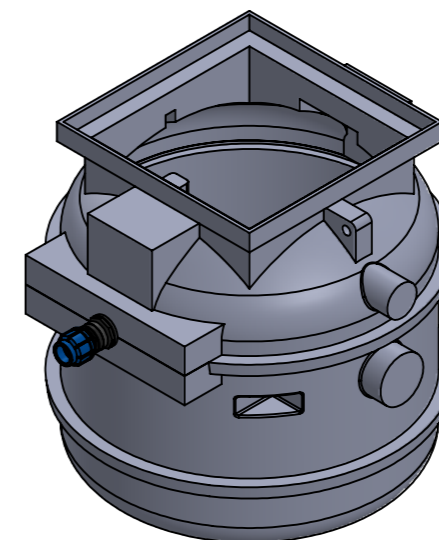

CUSTOMER:	
PRINT NAME:	
DATE:	
SIGNATURE:	

DUTYPOINT SETTING THE BAR

SHEPHERD ROAD, GLOUCESTER GL2 5EL
(T): 01452 300 110

PROPRIETARY & CONFIDENTIAL
DO NOT SCALE THIS DRAWING
IF IN DOUBT

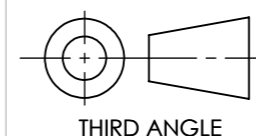

THIRD ANGLE

DRAWING NO:	10-005053-000			REV:	02.00	
BIM NO:	XXX-XXX-XX-XX-XX-X-XX_XX_XX-XXXX-XX-XXX					
DESCRIPTION:	T10.110.1P.50.GR					
PROJECT NAME:						
MODEL NO.						
SERIAL NO.				SHEET NO.	1 OF 1	
PROJECT NO.				SCALE:	1:20	
DRAWN BY:	DARREN LUSTY	25/04/2022	SHEET SIZE:	A3		
APPROVED BY:	-	-	WEIGHT KG:			