

- **IMPORTANT:** The tank must be surrounded in concrete as per installation procedures. Refer to installation manual available from Dutypoint Ltd.
- Inlets and cable entry points to be formed in the correct positions to suit site requirements. Further detail is available in the installation manual
- Dimensions are approximate due to manufacturing tolerances. If critical, check physically prior to installation.
- Manhole cover supplied separately to suit site requirements.

DUTYPOINT SETTING THE BAR

SHEPHERD ROAD, GLOUCESTER GL2 5EL
(T): 01452 300 110

PROPRIETARY & CONFIDENTIAL
DO NOT SCALE THIS DRAWING
IF IN DOUBT

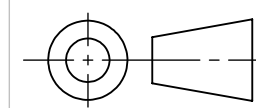

THIRD ANGLE

DRAWING NO:	10-005101-000		REV:	01.00
BIM NO:	XXX-XXX-XX-XX-XX-X-XX_XX_XX-XXXX-XX-XXX			
DESCRIPTION:	TBX.050.2P.50.FS			
PROJECT NAME:				
MODEL NO.				
SERIAL NO.			SHEET NO.	1 OF 1
PROJECT NO.			SCALE:	1:12
DRAWN BY:	DARREN LUSTY	03/05/2022	SHEET SIZE:	A3
APPROVED BY:	-	-	WEIGHT KG:	